



INSTRUCTIONS & PARTS LIST

MASTERFLEX® PUMP ADAPTER KITS #QP/M #RH/M

QP/M - INSTALLATION & OPERATING TIPS

TO MOUNT DIRECTLY TO A MASTERFLEX® L/S™ DRIVE (SEE FIG 1) OR TO EITHER THE MASTERFLEX® L/S™ STANDARD (SEE FIGURE 2) OR THE MASTERFLEX® L/S™ EASY-LOAD™ PUMP HEADS. (SEE FIG 3)

1. Mate your QP/M ADAPTER BRACKET 300204 to the Masterflex® Drive Unit by inserting one SCREW 110132-8 for direct to drive or the 110132-42 for the standard and Easy-Load pump heads and one LOCKWASHER 110049 through each appropriate corner holes on the QP/M ADAPTER BRACKET. Ensure that the center clearance hole on the QP/M ADAPTER BRACKET is aligned with the Masterflex® Drive Unit drive coupling slot. Tighten the four SCREWS 110132-8 or 110132-42.

2. Attach the DRIVE COUPLING H482-1 to the QP DRIVE SHAFT as shown, making sure that the SHAFT is bottomed in the COUPLING with shaft flat facing towards the set screw hole in the coupling.

3. Remove the Q647 MOUNTING BASE from your QP PEDESTAL PUMP if necessary. Mount the QP PEDESTAL PUMP drive module to the QP/M ADAPTER BRACKET using two SCREWS 110132-14 through the top of the QP mounting flanges and securing them with LOCK WASHERS 110049 and NUTS 110133 on the underside of the QP/M ADAPTER BRACKET. Align the DRIVE COUPLING to the Masterflex® Drive Unit drive coupling slot.

4. Insert the SUPPORT FOOT 110750 into the threaded insert located at the apex of the QP/M ADAPTER BRACKET from the underside. Adjust the height of the SUPPORT FOOT so that the QP/M ADAPTER BRACKET remains parallel to the base of the Masterflex® Drive Unit and that the weight of the QP/M assembly is resting on the SUPPORT FOOT.

5. Attach the desired PUMP HEAD MODULE to the QP PEDESTAL PUMP Drive Module and adjust for proper operation as described in the "Q" Pump Line Instructions Q431-.

6. Minimum height from centerline of output shaft to bottom of support foot (110750) is 3 inches.

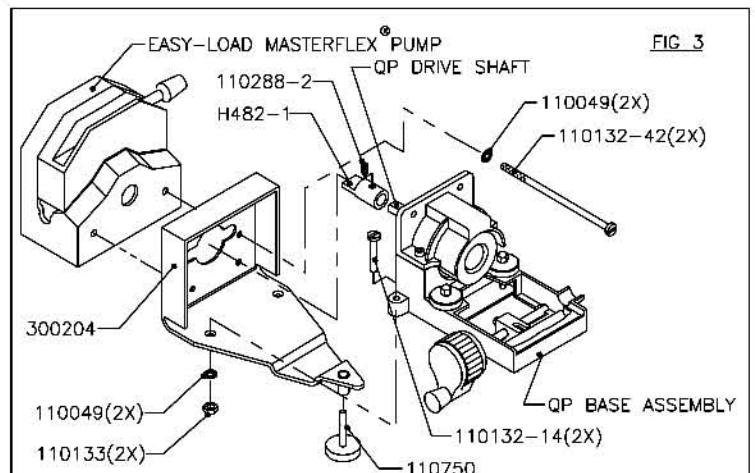
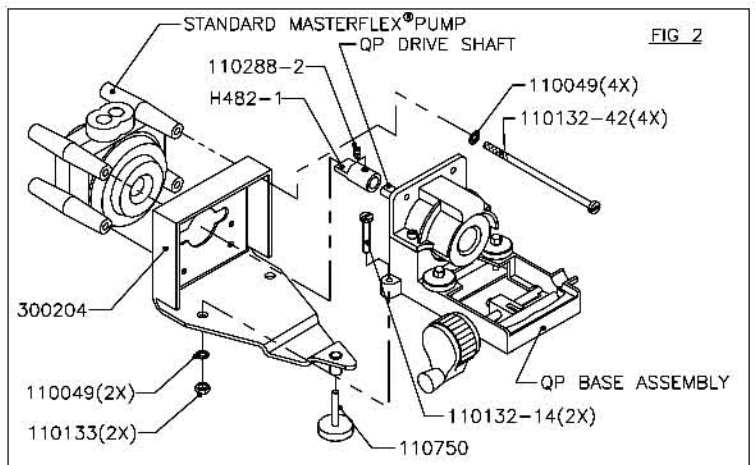
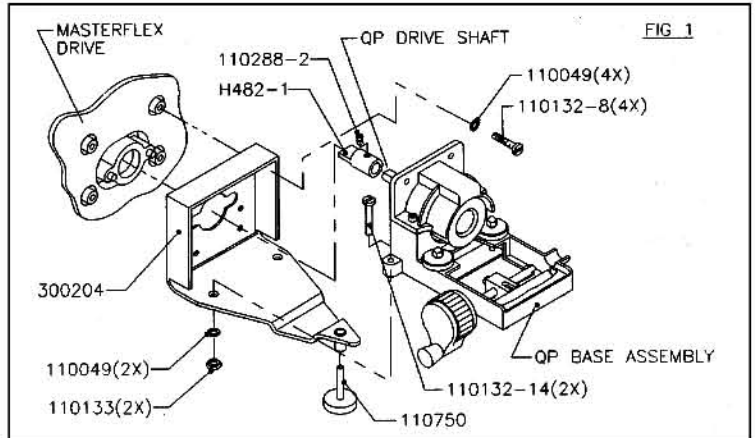

RH/M- INSTALLATION & OPERATING TIPS

FOR MOUNTING DIRECTLY TO A MASTERFLEX® L/S™ DRIVE (SEE FIGURE 4) FOR THE MASTERFLEX® L/S™ STANDARD PUMPHEAD (SEE FIGURE 5) AND FOR THE MASTERFLEX® L/S™ EASY-LOAD™ PUMP HEAD (SEE FIGURE 6).

1. Mate your PUMP HEAD (RH-CKC) with the ADAPTER PLATE H474 as shown making sure that the PUMP HEAD and the ADAPTER PLATE are correctly oriented: i.e. PUMP HEAD slot to the left, large hole in the PLATE in lower position.

2. Lock the PUMP HEAD and ADAPTER PLATE together by inserting a SCREW 110132-8, having a LOCK WASHER 110049 on it, through each of the two holes in the PLATE as shown and turning it tightly into the appropriate threaded hole in the PUMP HEAD.

3. Assemble COUPLING H482-1 on the PUMP HEAD SHAFT as shown making sure that the SHAFT is bottomed in the COUPLING with the flat surface of the shaft facing toward the screw hole in the COUPLING.

4. Tighten SET SCREW 110288-2 into the COUPLING.

5. Mount assembled RH/M KIT and RH PUMP HEAD on the Masterflex® Drive unit by inserting one SCREW 110132-18 (1-1/8" LONG) and on the Standard and Easy-Load Pump by inserting one SCREW 110132-54 (3-3/8" long) with one LOCK WASHER 110049 through each of the four corner holes for the Drive and Standard Pump models and through the two lower corner holes on the Easy-Load units.

6. Insert COUPLING H482-1 into the center hole and tighten the four SCREWS to complete installation. On the Easy-Load Pump use two HEX NUTS 110133 and LOCK WASHER 110049 to bolt to the back of the Easy-Load pump. Tighten the two SCREWS to complete installation.

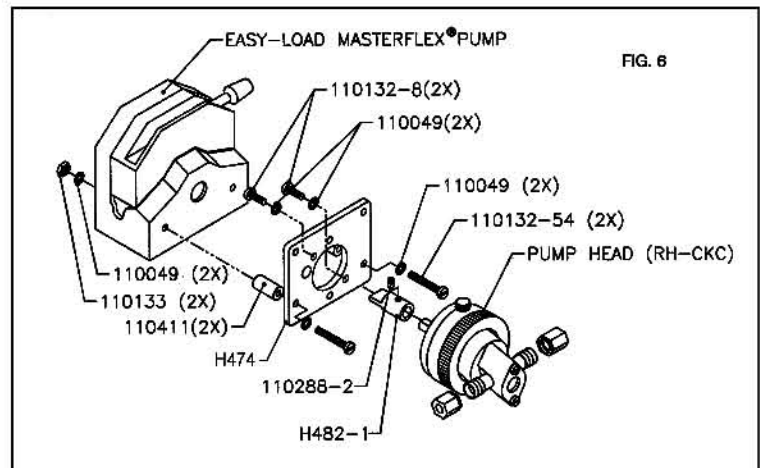
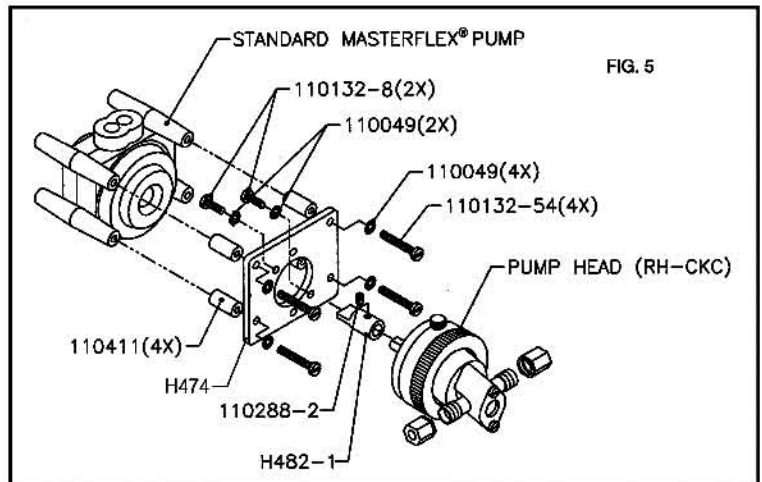
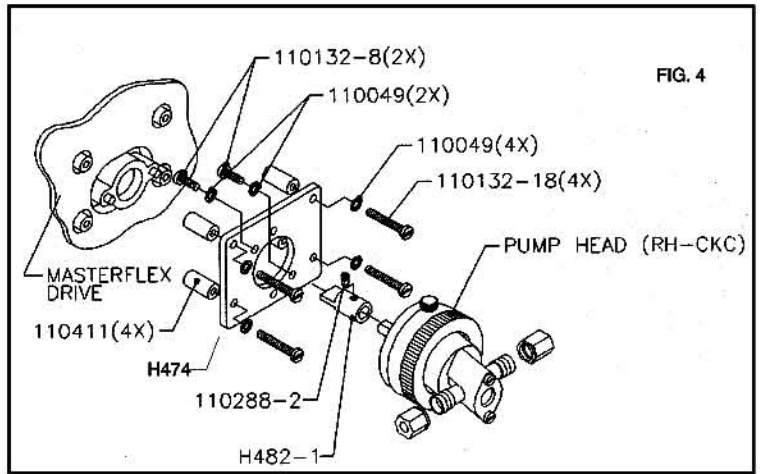

MASTERFLEX® L/S™ PUMP ADAPTER PARTS PRICE LIST

PART NO.	DESCRIPTION	QTY	PRICE
110049	WASHER, LOCK INT. TOOTH #8	8	
110132-8	SCREW, 8-32 X 1/2" PAN HEAD	4	
110132-14	SCREW, 8-32 X 7/8" PAN HEAD	2	
110132-18	SCREW, 8-32 X 1-1/8" PAN HEAD	4	
110132-42	SCREW, 8-32 X 2-5/8" PAN HEAD	4	
110132-54	SCREW, 8-32 X 3-3/8" PAN HEAD	4	
110133	NUT, HEX #8-32 X 11/32"	2	
110288-2	SET SCREW 8-32 X 1/8" LONG	1	
110411	SPACER 3/8" X 3/4" LONG	4	
110750	SUPPORT FOOT	1	
300204	QP/M ADAPTER BRACKET	1	
400081	QP PEDESTLE W/O Q647	1	
H474	ADAPTER PLATE, MASTERFLEX®	1	
H482-1	COUPLING, DRIVE	1	

MASTERFLEX® - Reg TM of Cole-Parmer Instrument Co.
EASY-LOAD® - Reg TM of Cole-Parmer Instrument Co.
L/S™ is a trademark of Cole-Parmer Instrument Co.

IMPORTANT!

WHEN ORDERING REPLACEMENT PARTS PLEASE MENTION MODEL & SERIAL NUMBERS OF PUMP ON WHICH THEY WILL BE USED.

PLEASE NOTE:

Pistons and cylinders should be dimensionally mated at factory. For most satisfactory performance, they can only be ordered as mated sets.

FOR ADDITIONAL INFORMATION CALL TOLL-FREE 800-223-3388
516-922-6050
FAX 516-624-8261



FLUID METERING, INC.

5 AERIAL WAY, SUITE 500, SYOSSET, NY 11791
(800) 223-3388 • (516) 922-6050 • FAX (516) 624-8261 • <http://www.fmipump.com>